

Revolving Handles

Plastic / Aluminum, Spindle Steel,
Mounting from the Back

SPECIFICATION

Handle

- Plastic Polyamide (PA) **KT**
 - Operating temperature up to 90 °C
 - Black, matte finish
- Aluminum **AL**
Polished

Spindle

Steel
Zinc plated, blue passivated

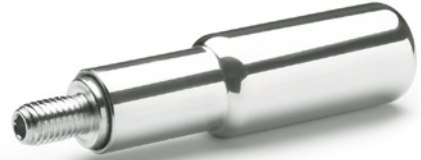

INFORMATION

The design of the revolving handles GN 798 is characterized by their shape, consisting of two cylinders. It gives the hand an excellent grip.

TECHNICAL INFORMATION

- Plastic Characteristics (see page A2)

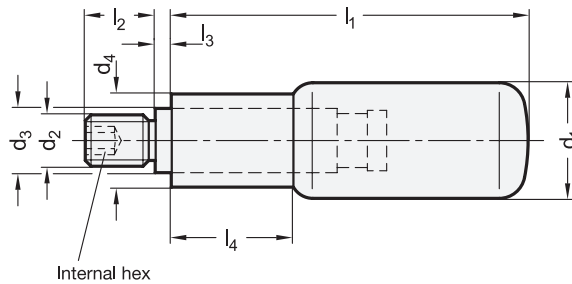

GN 798-KT

Description	d_1	d_2	d_3	d_4	l_1	l_2	$l_3 \approx$	l_4	$\Delta\Delta$
GN 798-KT-16-M6	16	M 6	10	13	41.5	12	2.5	15	30
GN 798-KT-18-M6	18	M 6	10	14.5	56	13	2.5	19	33
GN 798-KT-18-M8	18	M 8	10	14.5	56	13	2.5	19	37
GN 798-KT-22-M6	22	M 6	14	18.5	59	14	2.5	21	80
GN 798-KT-22-M8	22	M 8	14	18.5	59	14	2.5	21	81
GN 798-KT-22-M10	22	M 10	14	18.5	59	14	2.5	21	85
GN 798-KT-24-M8	24	M 8	14	18.5	74	16	2.5	27	93
GN 798-KT-24-M10	24	M 10	14	18.5	74	16	2.5	27	95
GN 798-KT-25-M10	25	M 10	16	20	84	16	2.5	30	130

GN 798-AL

Description	d_1	d_2	d_3	d_4	l_1	l_2	$l_3 \approx$	l_4	$\Delta\Delta$
GN 798-AL-16-M6	16	M 6	10	13	41.5	12	2.5	15	40
GN 798-AL-18-M6	18	M 6	10	14.5	56	13	2.5	19	50
GN 798-AL-18-M8	18	M 8	10	14.5	56	13	2.5	19	60
GN 798-AL-22-M6	22	M 6	14	18.5	59	14	2.5	21	95
GN 798-AL-22-M8	22	M 8	14	18.5	59	14	2.5	21	100
GN 798-AL-22-M10	22	M 10	14	18.5	59	14	2.5	21	103
GN 798-AL-24-M8	24	M 8	14	18.5	74	16	2.5	27	120
GN 798-AL-24-M10	24	M 10	14	18.5	74	16	2.5	27	130
GN 798-AL-25-M10	25	M 10	16	20	84	16	2.5	30	150